

- ✓ DIN 914
- ✗ ISO 4027
- ✓ UNI 5927

**GEIP**

**VITI SENZA TESTA CAVA ESAGONALE ESTR. A PUNTA**  
**HEXAGON SOCKET SET SCREWS WITH CONE POINT**  
**GEWINDESTIFTE MIT INNENSECHSKANT UND SPITZE**  
**VIS SANS TETE A SIX PANS CREUX A BOUT POINTU**

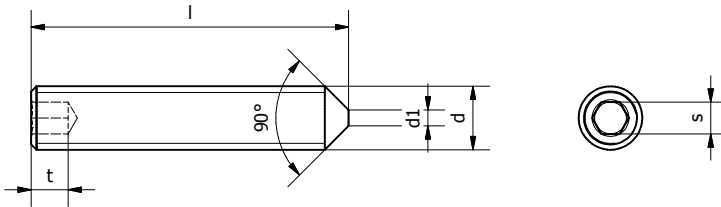

**Dimensions in mm**

d Filetto/Thread	M3	M4	M5	M6	M8	M10	M12	M14	M16	M20
t	2	2,5	3	3,5	5	6	8	A RICHIESTA ON DEMAND		
s	1,5	2	2,5	3	4	5	6			
l max	15	20	25	30	40	50	60			
d1	-	-	-	1,5	2	2,5	3			

**CODE EXAMPLE:**

**128** + material + thread + pitch + length + color

GEIP M6x20 Al7075 white = 128106020B

GEIP M8x30 Ti GR5 blue = 128508030K