

# 130

COD.

## GEIPI

- ✓ DIN 916
- ✓ ISO 4029
- ✓ UNI 5929

**VITI SENZA TESTA CAVA ESAGONALE PUNTA INCASSATA**  
**HEXAGON SOCKET SET SCREWS WITH CUP POINT**  
**GEWINDESTIFTE MIT INNENSECHSKANT UND RINGSCHNEIDE**  
**VIS SANS TETE A' SIX PANS CREUX BOUT CUVETTE**

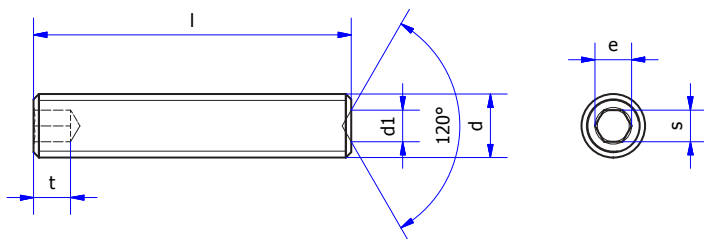

Dimensions in mm

d Filetto/Thread	M3	M4	M5	M6	M8	M10	M12	M14	M16	M20
t	2	2,5	3	3,5	5	6	8	A RICHIESTA ON DEMAND		
s	1,5	2	2,5	3	4	5	6			
e min	1,73	2,3	2,87	3,44	4,58	5,72	6,86			
l max	15	20	25	30	40	50	60			
d1 max	1,4	2	2,5	3	5	6	8			

**CODE EXAMPLE:**

**130** + material + thread + pitch + length + color

GEIPI M6x20 Al7075 white = 121106020B

GEIPI M8x30 Ti GR5 blue = 121508030K

44

