

- ✓ DIN 835 - 938
- ✓ DIN 939 - 940
- ✓ UNI 5909-5919

TIR

VITI PRIGIONIERE
STUD BOLTS
STIFTSCHRAUBEN
GOUJONS

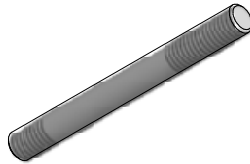
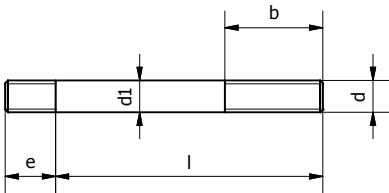

Dimensions in mm

Dimensions in mm		M3	M4	M5	M6	M8	M10	M12	M14	M16	M20
d1 Filetto/Thread			4	5	6	8	10	12	14	16	20
l	12		10÷40	12÷50	14÷70	16÷100	18÷120	22÷140	25÷160	28÷170	35÷200
b	$l \leq 125$		14	16	18	22	26	30	34	38	46
	$125 < l \leq 200$		-	-	-	-	-	36	40	44	52
	$l > 200$		-	-	-	-	-	-	-	-	-
e	X = rad.corta/short (DIN 938)		4	5	6	8	10	12	14	16	20
	Y = rad.media/medium (DIN 939)		6	7	9	12	15	18	20	22	28
	W = rad.lunga/long (DIN 835)		8	10	12	16	20	24	28	32	40
	T = rad.extra lunga/extra long (DIN 940)		10	13	15	20	25	32	35	40	50

NOTE: aggiungere alla fine del codice la lettera corrispondente radice e desiderata
to indicate the root you need, add the corresponding letter to the end of the code

CODE EXAMPLE:

400 + material + thread + pitch + length + color + root

TIR M6x20 Al7075 white rad.corta = 400106020BX

TIR M8x30 Ti GR5 blue extra long = 400508030KT